

MS series aluminium housing three-phase asynchronous motors, with latest design in entirety, It's made of superior materials and conform to the IEC standard.
MS motors have good performance, safety reliable operation and nice appearance, it can be maintained very conveniently while with low noises, little vibration, light weight and simple construction. These series motors can be used for general drive.



ALUMINIUM HOUSING

MS EMS SERIES

THREE-PHASE ASYNCHRONOUS MOTORS

OPERATING CONDITIONS

- Ambient temperature: $-15^{\circ}\text{C} \leq \leq 40^{\circ}\text{C}$
- Above sea level: not exceed 1000m
- Rated voltage: $\pm 5\%$
- Protection Class: IP44/IP54/IP55
- Insulation Class: B/F
- Cooling method: ICO141
- Duty: continuous(S)

TECHNICAL DATA AT 50Hz

TYPE	Power (KW)	Current (A)			Speed (r/min)	Eff (%)	Power Factor	Tstart/Tn (Times)	Tmax/Tn (Times)	Ist/In (Times)
		220V	380V	660V						
MS561-2	0.09	0.64	0.37		2670	57	0.65	2.2	2.4	6
MS562-2	0.12	0.74	0.43		2730	62	0.69	2.2	2.4	6
MS563-2	0.18	1.0	0.58		2750	65	0.72	2.2	2.4	6
MS631-2	0.18	1.00	0.58		2710	63	0.75	2.2	2.4	6
MS632-2	0.25	1.29	0.75		2710	65	0.78	2.2	2.4	6
MS633-2	0.37	1.92	1.11		2710	65	0.78	2.2	2.4	6
MS711-2	0.37	1.76	1.02		2730	70	0.79	2.2	2.4	6
MS712-2	0.55	2.57	1.49		2760	71	0.79	2.2	2.4	6
MS713-2	0.75	3.33	1.93		2730	72	0.82	2.2	2.4	6
MS801-2	0.75	3.21	1.86		2770	73	0.84	2.2	2.4	6
MS802-2	1.1	4.56	2.64		2770	76	0.83	2.2	2.4	6
MS803-2	1.5	6.04	3.50		2800	78	0.83	2.2	2.4	6
MS90S-2	1.5	5.97	3.46		2840	78	0.84	2.2	2.4	6
MS90L1-2	2.2	8.39	4.85		2840	81	0.85	2.2	2.4	6
MS90L2-2	3	11.08	6.42		2840	82	0.86	2.2	2.4	6
MS100L1-2	3	10.96	6.34		2840	82	0.87	2.2	2.3	7
MS100L2-2	4		8.30	4.78	2850	84	0.87	2.2	2.3	7.5
MS112M-2	4		8.30	4.78	2880	84	0.87	2.2	2.3	7.5
MS112L-2	5.5		11.08	6.38	2880	85	0.88	2.2	2.3	7.5
MS132S1-2	5.5		11.08	6.38	2900	85	0.88	2.0	2.2	7.5
MS132S2-2	7.5		14.88	8.57	2920	87	0.88	2.0	2.2	7.5
MS132M1-2	9.2		17.85	10.28	2930	88	0.89	2.0	2.2	7.5
MS132M2-2	11		21.01	12.09	2930	88	0.9	2.0	2.2	7.5
MS160M1-2	11		21.01	12.09	2940	88	0.9	2.0	2.2	7.5
MS160M2-2	15		28.01	16.13	2940	89	0.91	2.0	2.2	7.5
MS160L-2	18.5		34.32	19.76	2940	90	0.91	2.0	2.2	7.5

TECHNICAL DATA AT 50Hz

TYPE	Power (KW)	Current (A)			Speed (r/min)	Eff (%)	Power Factor	Tstart/Tn (Times)	Tmax/Tn (Times)	Ist/In (Times)
		220V	380V	660V						
MS561-4	0.06	0.55	0.32		1320	48	0.59	2.3	2.4	6
MS562-4	0.09	0.77	0.45		1320	50	0.61	2.3	2.4	6
MS563-4	0.12	0.96	0.56		1320	52	0.63	2.2	2.4	6
MS631-4	0.12	0.86	0.50		1350	57	0.64	2.2	2.4	6
MS632-4	0.18	1.23	0.71		1350	59	0.65	2.2	2.4	6
MS633-4	0.25	1.66	0.96		1350	60	0.66	2.2	2.4	6
MS711-4	0.25	1.52	0.88		1350	60	0.72	2.2	2.4	6
MS712-4	0.37	2.02	1.17		1370	65	0.74	2.2	2.4	6
MS713-4	0.55	2.92	1.69		1380	66	0.75	2.2	2.4	6
MS801-4	0.55	2.87	1.66		1370	67	0.75	2.2	2.4	6
MS802-4	0.75	3.50	2.03		1380	72	0.78	2.2	2.4	6
MS803-4	1.1	4.86	2.81		1390	76	0.78	2.2	2.4	6
MS90S-4	1.1	4.80	2.78		1400	76	0.79	2.2	2.4	6
MS90L1-4	1.5	6.27	3.63		1400	78	0.8	2.2	2.4	6
MS90L2-4	2.2	8.91	5.16		1400	81	0.8	2.2	2.3	7
MS100L1-4	2.2	8.80	5.09		1420	81	0.81	2.2	2.3	7
MS100L2-4	3	11.77	6.81		1420	82	0.81	2.2	2.2	7
MS100L3-4	4		8.80	5.07	1430	84	0.82	2.2	2.2	7
MS112M-4	4		8.70	5.01	1430	84	0.83	2.2	2.2	7
MS112L-4	5.5		11.75	6.76	1440	85	0.83	2.2	2.2	7
MS132S-4	5.5		11.61	6.68	1450	85	0.84	2.2	2.2	7
MS132M-4	7.5		15.41	8.87	1450	87	0.85	2.2	2.2	7
MS132L1-4	9.2		18.79	10.82	1460	87	0.85	2.2	2.2	7.5
MS132L2-4	10		20.31	11.69	1460	88	0.85	2.2	2.2	7.5
MS132L3-4	11		21.98	12.66	1460	88	0.86	2.2	2.2	7.5
MS160M-4	11		21.73	12.51	1460	88	0.87	2.2	2.2	7
MS160L-4	15		29.63	17.06	1460	88	0.87	2.2	2.2	7.5
MS801-6	0.37	2.24	1.30		900	62	0.7	1.9	1.9	4
MS802-6	0.55	2.99	1.73		900	67	0.72	2	2.3	4
MS803-6	0.75	4.02	2.33		900	68	0.72	2	2.3	4
MS90S-6	0.75	3.96	2.29		920	69	0.72	2.2	2.2	5.5
MS90L-6	1.1	5.49	3.18		925	72	0.73	2.2	2.2	5.5
MS100L-6	1.5	7.00	4.05		945	74	0.76	2.2	2.2	6
MS112M-6	2.2	9.74	5.64		955	78	0.76	2.2	2.2	6
MS132S-6	3	13.11	7.59		960	79	0.76	2	2	6.5
MS132M1-6	4		9.93	5.72	960	80	0.76	2	2	6.5
MS132M2-6	5.5		13.08	9.54	960	83	0.77	2	2	6.5
MS132L-6	7.5		17.41	13.92	960	85	0.77	2	2	6.5
MS160M-6	7.5		16.56		960	86	0.8	2	2.2	6.5
MS160L-6	11		24.18		960	87	0.79	2	2.2	6.5

EMS SERIES IE2 EFFICIENCY MOTORS TECHNICAL DATA (AT 400V/50HZ)

Model	Power (KW)	Eff (%)	Current (A)	Power Factor (Cos ϕ)	Speed (r/min)	Tmax/Tn (Times)	Ts/Tn (Times)	Ist/In (Times)
EMS801-2	0.75	77.4	1.68	0.8	2840	3.3	2.9	5.8
EMS802-2	1.1	80	2.42	0.82	2850	3.6	3.5	6.8
EMS90S-2	1.5	81.4	3.2	0.83	2850	3.6	3.5	6.9
EMS90L-2	2.2	83.2	4.48	0.84	2860	4.1	4.1	7.9
EMS100L-2	3	84.6	5.88	0.87	2880	3.4	3.4	7.8
EMS112M-2	4	86	7.54	0.89	2890	3.3	2.7	7.5
EMS132S-2	5.5	87.2	10.42	0.89	2900	3	2.4	7.7
EMS132M-2	7.5	88.1	13.91	0.89	2910	3.2	2.6	8.4
EMS160M1-2	11	89.4	20.34	0.89	2930	3.1	2.4	7.6
EMS160M2-2	15	90.3	26.54	0.89	2930	3.2	2.6	8
EMS160L-2	18.5	90.9	32.41	0.9	2940	3.5	3	9
EMS802-4	0.75	79.6	1.79	0.76	1410	3	2.8	5.3
EMS90S-4	1.1	81.4	2.5	0.78	1420	2.6	3.8	6.7
EMS90L-4	1.5	82.8	3.76	0.79	1420	2.7	4	7.2
EMS100L1-4	2.2	84.3	4.83	0.78	1440	3.6	3.6	7.4
EMS100L2-4	3	85.5	6.33	0.8	1440	3.5	3.8	7.8
EMS112M-4	4	86.6	8.23	0.81	1440	2.9	3.1	7.1
EMS132S-4	5.5	87.9	10.6	0.83	1450	2.7	2.6	7.4
EMS132M-4	7.5	88.7	14.15	0.84	1450	2.7	2.8	7.7
EMS160M-4	11	89.8	20.15	0.82	1450	3.1	2.7	7.7
EMS160L-4	15	90.6	28.4	0.84	1450	2.6	2.4	7.3
EMS90S-6	0.75	76	2.01	0.71	925	3.1	3.1	4.7
EMS90L-6	1.1	78.1	2.82	0.72	930	3.2	3.2	5
EMS100L-6	1.5	80	3.71	0.73	940	2.9	3.1	5.9
EMS112M-6	2.2	81.8	5.23	0.75	945	2.8	2.6	5.5
EMS132S-6	3	83.3	6.69	0.76	960	2.7	2.2	5.7
EMS132M1-6	4	84.6	9.07	0.77	960	2.7	2.4	6.2
EMS132M2-6	5.5	86	12	0.77	960	2.7	2.6	6.7
EMS160M-6	7.5	87.5	19.18	0.77	970	2.8	2	5.6
EMS160L-6	11	89	27.53	0.78	970	2.8	2	5.8

IMB3

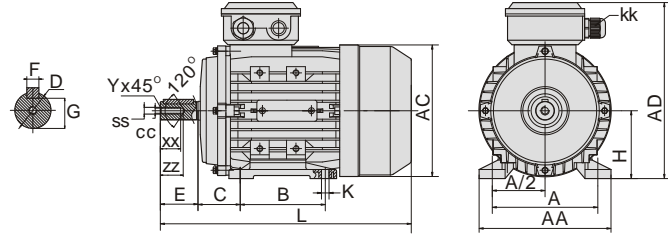

IMB5

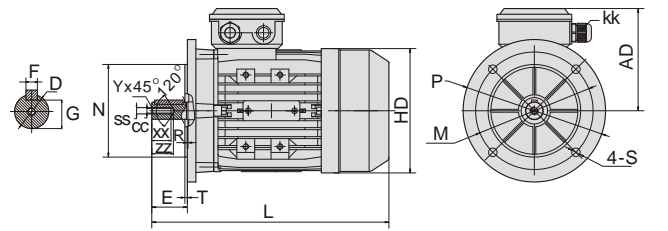

IMB14

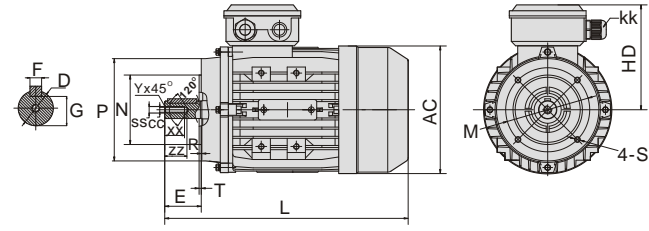

B3 OVERALL & INSTALLATION DIMENSION

Frame	H	A	B	C	D	E	F	G	K	AA	AD	AC	L	KK	SS	XX	ZZ	CC	Y
56	56	90	71	36	9	20	3	7.2	5.8X5.8	110	156/151	φ120	195	1-M16X1.5	M3	8	12	2.5	0.5
63	63	100	80	40	11	23	4	8.5	7X10	120	173/165	φ130	230	1-M16X1.5	M4	10	15	3.3	0.8
71**	71	112	90	45	14	30	5	11	7X10	132	188/180	φ145	260	1-M20X1.5	M5	12	18	4.2	0.8
80	80	125	100	50	19	40	6	15.5	10X13	160	217	φ165	295	1-M20X1.5	M6	16	22	5	1
90S	90	140	100	56	24	50	8	20	10X13	175	235	φ185	335	1-M20X1.5	M8	20	25	6.8	1
90L1/L2	90	140	125	56	24	50	8	20	10X13	175	235	φ185	365	1-M20X1.5	M8	20	25	6.8	1
100**	100	160	140	63	28	60	8	24	12X16	196	252	φ205	400	1-M20X1.5	M10	22	28	8.5	1.5
112	112	190	140	70	28	60	8	24	12X16	220	292	φ230	400	2-M25X1.5	M10	22	28	8.5	1.5
132S	132	216	140	89	38	80	10	33	12X16	252	325	φ270	440	2-M25X1.5	M12	28	34	10.2	1.5
132M/L	132	216	178	89	38	80	10	33	12X16	252	325	φ270	480/500	2-M25X1.5	M12	28	34	10.2	1.5
160M/L	160	254	210/254	108	42	110	12	37	15X19	290	390	φ320	640	2-M32X1.5	M16	35	42	14.2	2

B5 OVERALL & INSTALLATION DIMENSION

Frame	B5					B5R					D	E	F	G	KK	AC	HD	L	SS	XX	ZZ	CC	Y		
	M	N	P	T	S	R	M	N	P	T														S	R
56	φ98	φ80	φ120	3.0	φ7	0							φ9	20	3	7.2	1-M16X1.5	φ120	100/95	195	M3	8	12	2.5	0.5
63	φ115	φ95	φ140	3.0	φ10	0							φ11	23	4	8.5	1-M16X1.5	φ130	110/102	230	M4	10	15	3.3	0.8
71**	φ130	φ110	φ160	3.5	φ10	0							φ14	30	5	11	1-M20X1.5	φ145	117/109	260	M5	12	18	4.2	0.8
80	φ165	φ130	φ200	3.5	φ12	0							φ19	40	6	15.5	1-M20X1.5	φ165	137	295	M6	16	22	5	1
90S	φ165	φ130	φ200	3.5	φ12	0							φ24	50	8	20	1-M20X1.5	φ185	145	335	M8	20	25	6.8	1
90L1/L2	φ165	φ130	φ200	3.5	φ12	0							φ24	50	8	20	1-M20X1.5	φ185	145	365	M8	20	25	6.8	1
100**	φ215	φ180	φ250	4.0	φ15	0							φ28	60	8	24	1-M20X1.5	φ205	152	400	M10	22	28	8.5	1.5
112	φ215	φ180	φ250	4.0	φ15	0							φ28	60	8	24	2-M25X1.5	φ230	180	400	M10	22	28	8.5	1.5
132S	φ265	φ230	φ300	4.0	φ15	0							φ38	80	10	33	2-M25X1.5	φ270	193	440	M12	28	34	10.2	1.5
132M/L	φ265	φ230	φ300	4.0	φ15	0							φ38	80	10	33	2-M25X1.5	φ270	193	480/500	M12	28	34	10.2	1.5
160M/L	φ300	φ250	φ350	5.0	φ19	0							φ42	110	12	37	2-M32X1.5	φ320	230	640	M16	35	42	14.2	2

B14 OVERALL & INSTALLATION DIMENSION

Frame	B14					B14B					D	E	F	G	KK	AC	HD	L	SS	XX	ZZ	CC	Y		
	N	M	P	T	S	R	N	M	P	T														S	R
56	φ50	φ65	φ80	2.5	M5	0							φ9	20	3	7.2	1-M16X1.5	φ120	100/95	195	M3	8	12	2.5	0.5
63	φ60	φ75	φ90	2.5	M5	0							φ11	23	4	8.5	1-M16X1.5	φ130	110/102	230	M4	10	15	3.3	0.8
71**	φ70	φ85	φ105	2.5	M6	0							φ14	30	5	11	1-M20X1.5	φ145	117/109	260	M5	12	18	4.2	0.8
80	φ80	φ100	φ120	3.0	M6	0							φ19	40	6	15.5	1-M20X1.5	φ165	137	295	M6	16	22	5	1
90S	φ95	φ115	φ140	3.0	M8	0							φ24	50	8	20	1-M20X1.5	φ185	145	335	M8	20	25	6.8	1
90L1/L2	φ95	φ115	φ140	3.0	M8	0							φ24	50	8	20	1-M20X1.5	φ185	145	365	M8	20	25	6.8	1
100**	φ110	φ130	φ160	3.5	M8	0							φ28	60	8	24	1-M20X1.5	φ205	152	400	M10	22	28	8.5	1.5
112	φ110	φ130	φ160	3.5	M8	0							φ28	60	8	24	2-M25X1.5	φ230	180	400	M10	22	28	8.5	1.5
132S	φ130	φ165	φ200	3.5	M10	0							φ38	80	10	33	2-M25X1.5	φ270	193	440	M12	28	34	10.2	1.5
132M/L	φ130	φ165	φ200	3.5	M10	0							φ38	80	10	33	2-M25X1.5	φ270	193	480/500	M12	28	34	10.2	1.5

**This frame size has two housing size, the rated output is for normal "L" size, and increased output is for the bigger "L" size (refer to the figures in the bracket "()")

IMB35

